

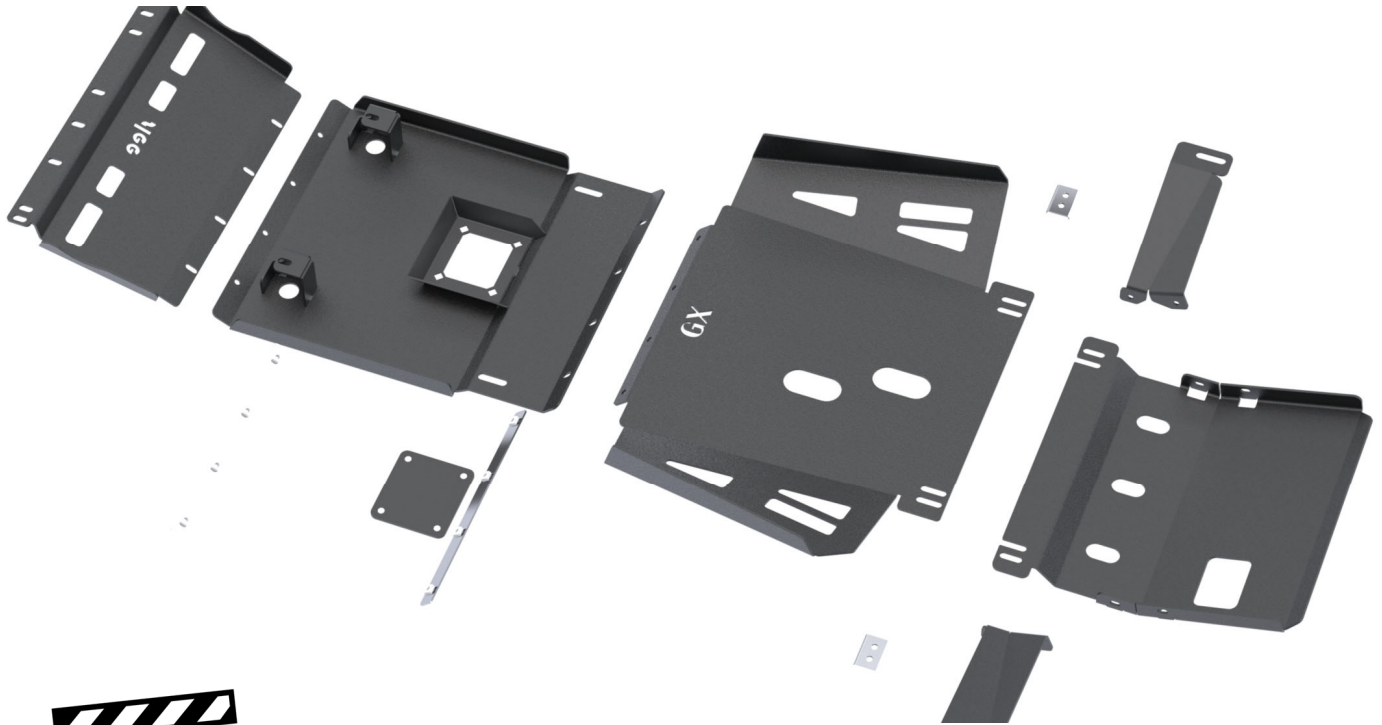

700 Pine Ridge Road Golden CO 80403 Tel (303) 278 8287 1(888) 4X4 SLEE Fax (303) 278 7182

**Slee Off-Road – [Lexus GX470 & GX460, FJ Cruiser, 5th Gen 4Runner Skid Plate System]
(SOK2080 or SOK2087) – Installation instruction 1**



NOTE: - These diagrams and photos for these instructions are from a GX470 & GX460. However the FJ Cruiser and 5th Gen 4Runner skid plates are essentially the same in terms of installation. These instructions cover the SOK2080 and SOK2087 part numbers.

SCAN FOR COMPLETE INSTALLATION INSTRUCTIONS!

Thank you for your purchase from Slee Off-Road! If you should you have any questions or concerns, please do not hesitate to contact us immediately at 1 888 4X4 SLEE or at sales@sleeoffroad.com.

Slee Off-Road strives to provide comprehensive installation instructions. However, in some circumstances minor inconsistencies may be encountered with instructions and or provided parts. If you encounter such an inconsistency, please notify us, as your input is important.

Slee Off-Road guarantees all parts free from defects for one year from the original purchase date. Slee Off-Road and Slee & Co under no circumstances will be held liable for any damages or injuries to the users of this product(s) and or their equipment as a result of the use of this

ITEM NO.	DESCRIPTION	QTY.
1	TRANSMISSION SKID PLATE	1
2	ENGINE SKID PLATE	1
3	FRONT SKID PLATE	1
4	TRANSFER CASE SKID PLATE	1
5	DR TRANSFER CASE BRACKET	1
6	PS TRANSFER CASE BRACKET	1
7	BOLT ACCESS DOOR	1
8	OIL DRAIN PLUG COVER	2
9	NUT PLATE - 4 NUTS	2
10	STICK NUT 3/8 x 6"	2

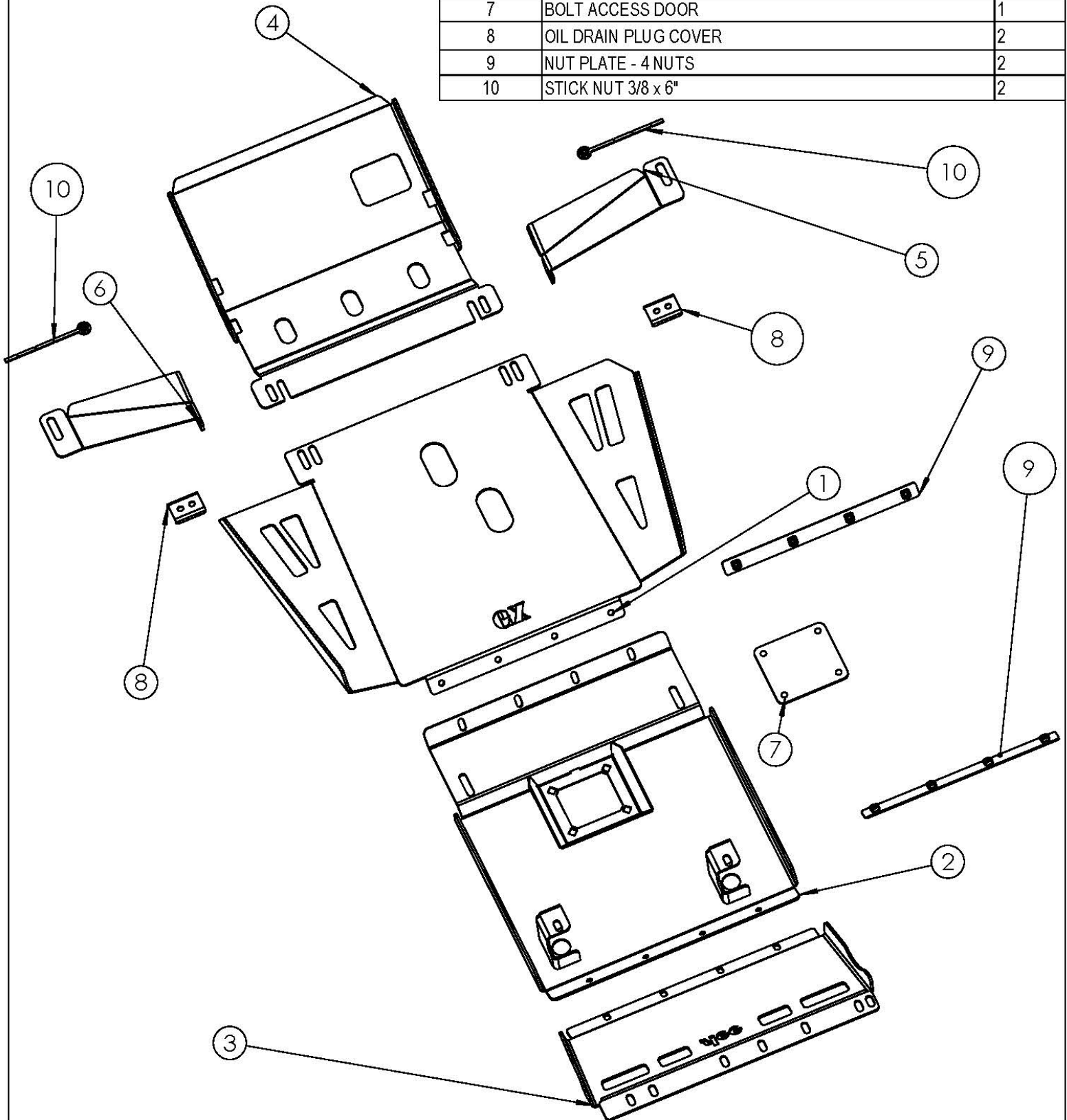

PROPRIETARY AND CONFIDENTIAL

THE INFORMATION CONTAINED IN THIS DRAWING IS THE SOLE PROPERTY OF SLEE OFF-ROAD. ANY REPRODUCTION IN PART OR AS A WHOLE WITHOUT THE WRITTEN PERMISSION OF SLEE OFF-ROAD IS PROHIBITED.

DESCRIPTION: **BOLT ON SKID PLATE SYSTEM**
 PART NUMBER: **SFP2080**
 PART NAME: **GX SKID SYSTEM**



Slee Off-Road – [Lexus GX470 & GX460, FJ Cruiser, 5th Gen 4Runner Skid Plate System]
 (SOK2080 or SOK2087) – Installation instruction 3

QTY	Parts Included
1	SLEE Transmission Skid Plate
1	SLEE Engine Skid Plate
1	SLEE Front Skid Plate
1	SLEE Transfer Case Skid Plate
1	SLEE DS Transfer Case Bracket
1	SLEE PS Transfer Case Bracket
1	SLEE Oil Drain Cover
2	Skid-to-Skid Nut plates 3/8-16 (4 nuts)
2	Stick Nuts 2/8-16—6"
2	Bolt Protection Washers
1	Front Skid Support Bracket
8	Button Head Cap Screw 3/8-16 x 1-1/4"
6	Bolts Grade 5 3/8-16 x 1"
4	Flat Head Cap Screw 3/8-16 x 1-1/2"
4	Clip Nut Steel, 3/8-16 Thread
4	Lock Nut 3/8-16 Grade 5
2	Lock Washers 3/8
18	Flat Washer 3/8" USS
2	Thick Flat Washer 3/8"
2	M8 x 40mm - Button Head Bolt - [1.25 pitch] zinc clear
2	M8 - Fender Washer - thick (1/8") zinc clear
2	Aluminum Spacer 3/4 od
8	M8 x 35mm - Flange Bolt - [1.25 pitch] zinc clear
2	M10 x 30mm - Flange Bolt - [1.25 pitch] class 10.9 zinc clear
4	M10 - Washer - Thick 25mm OD zinc clear

Tools
Standard Hand Tools—Metric and SAE

Slee Off-Road – [Lexus GX470 & GX460, FJ Cruiser, 5th Gen 4Runner Skid Plate System]
(SOK2080 or SOK2087) – Installation instruction 4

1 Gather and inspect kit hardware.
Remove factory skid plates and associated brackets from the truck.

Also remove the two front braces as well as the two braces at the catalytic converter.

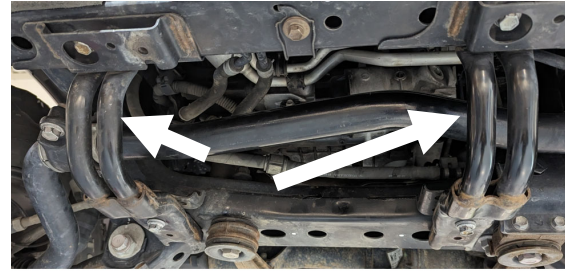

Step 1 : Braces to be removed.

2 Install the clip nuts into the square holes on the Engine Skid Plate. The nut side towards the truck. **Do not install cover plates at this time.**

Hardware:

4 - 3/8 Clip Nuts



Step 2: Install Clip Nuts

3 Install **Engine Skid Plate** first. Support the engine skid plate on a jack stand or with a helper.

Install the two M8 Flange bolts with washers through the opening in the front part of the engine skid plate. Thread into the frame locations with the aluminum spacers between the plate and the frame.

Install the M8 button head bolts with large washers on the rear of the skid plate. Do not tighten. Just thread enough to support plate.

Hardware:

2 x M8 x 35mm - Flange Bolt - [1.25 pitch] zinc clear

2 x Flat Washer 3/8" USS

2 x M8 x 40mm - Button Head Bolt - [1.25 pitch] zinc clear

2 x Aluminum Spacer 3/4 od

2 x M8 - Fender Washer - thick (1/8") zinc clear

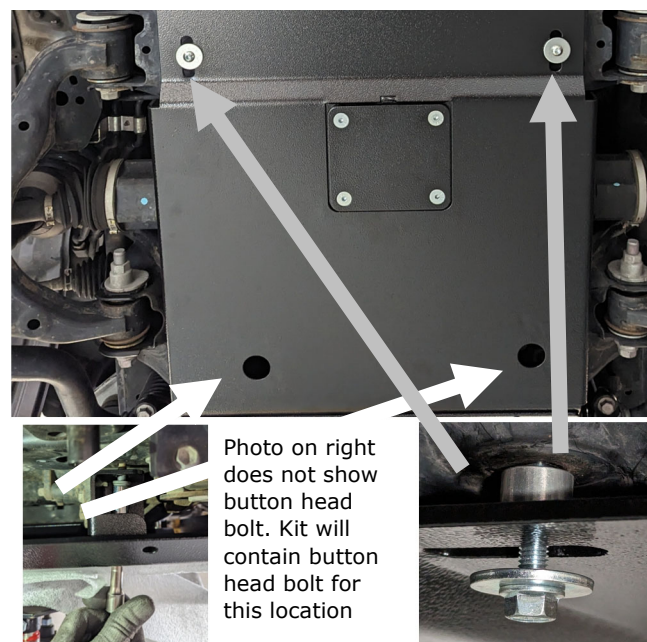

Step 3: Engine skid plate attachment locations and hardware.

Slee Off-Road – [Lexus GX470 & GX460, FJ Cruiser, 5th Gen 4Runner Skid Plate System]
(SOK2080 or SOK2087) – Installation instruction 5

4 Next install the **Transmission Skid Plate**

Place the nut plate on the back flange of the engine skid plate. Nuts should face away from the flange.

Support the skid plate and install two M8 bolts in the inner most slots into the cross member (rear section of skid plate). Leave loose

Use the 3/8" Button Head bolts with washers and attach the front lip of the skid plate to the nut plate while sandwiching the engine skid plate. Do not tighten.

Hardware:

- 1- Nut plate (4 nuts)
- 4 - Button Head Cap Screw 3/8-16 x 1-1/4"
- 4 - Flat Washer 3/8" USS
- 2 - M8 x 35mm - Flange Bolt - [1.25 pitch] zinc clear

Hint: Do not tighten at this time.

5 Install the **DS and PS Transfer Case Brackets** to the **Transfer Case Skid Plate** as shown. Use 3/8 hex bolts with washers and lock nuts. For orientation of bracket refer to photograph. Slot is towards the rear of the vehicle.

Hardware:

- 4 - Bolts Grade 5 3/8-16 x 1"
- 4 - Lock Nut 3/8-16 Grade 5
- 8 - Flat Washer 3/8" USS



Step 4: Insert nut plate



Step 4: M8 Flange bolts installed in innermost slots.



Step 5: Transfer Case Bracket installed on Transfer Case Skid Plate.

Slee Off-Road – [Lexus GX470 & GX460, FJ Cruiser, 5th Gen 4Runner Skid Plate System]
(SOK2080 or SOK2087) – Installation instruction 6

6 Install the **Transfer Case Skid**.

Start by bending the stick nut at a 90 degree right at the nut. Then locate the rectangular hole on the inside of the driver side frame behind the transfer case cross member. Take a rough measurement to the hole opening and bend another 90 degree bend in the stick nut in the opposite direction.

Insert stick nut into rectangular opening with the nut section towards the front and bottom. Repeat for other side as well.

Slide the Transfer Case skid plate under the Transmission Skid Plate on the front (Align the slots).

Support the skid plate in place and use the 3/8" hex bolts with lock and **thick flat washers** to attach the side brackets to the frame by bolting to the stick nuts through the holes in the bottom of the frame.

Once the brackets are attached remove one of the front M8 bolts, and install the bolt protection washers with two M8 flange bolts and sandwich Transfer and Transmission Skid Plate.

Hardware:

- 2 - Stick Nuts 2/8-16—6"
- 2 - Bolts Grade 5 3/8-16 x 1"
- 2 - Lock Washers 3/8
- 2 - Thick Flat Washer 3/8" USS
- 2 - Bolt Protection Washers
- 2 - M8 x 35mm - Flange Bolt - [1.25 pitch] zinc clear

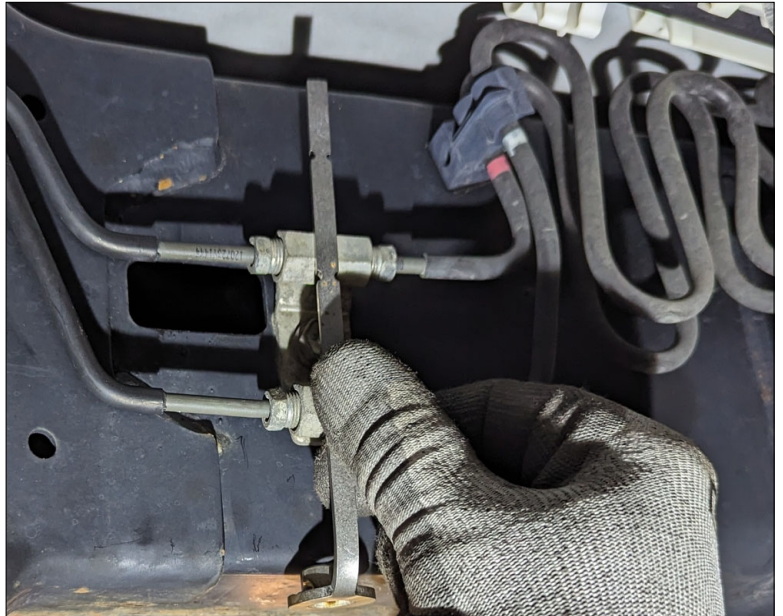

Step 6: Stick nut with one bend already made. Location of rectangular opening in frame rail

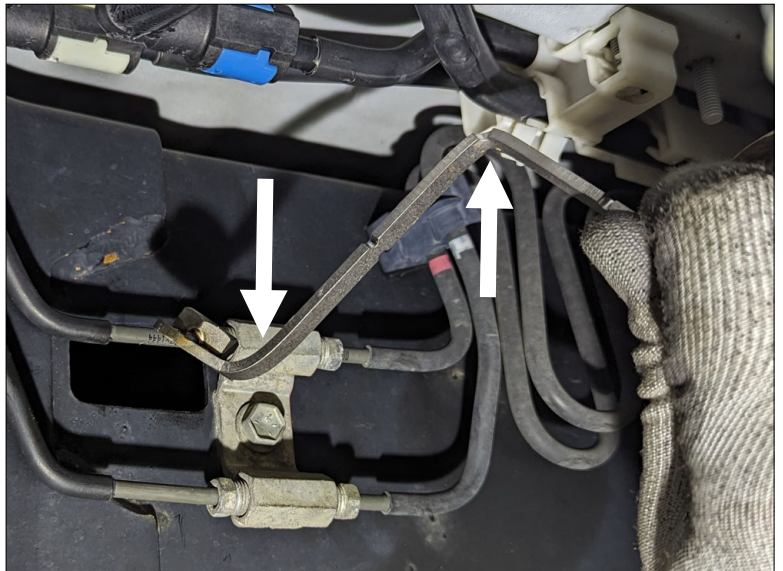

Step 6: Stock nut with both bends made.



Step 6: Bolt Protection Washer installed with M8 Flange Nuts



Step 6: Sliding Transfer Case Skid Plate under Transmission Skid

6 - Continued

Photograph on right shows driver side Transfer Case Bracket installed to frame rail with stick nut inside frame rail.



Step 6: Transfer Case Bracket installed to frame with stick nut inside frame rail

7 Now install the Front Skid Plate

Place the nut plate on the front lip of the engine skid plate. Nut should face away from the skid plates.

There are two brackets that hold power steering lines in place. Use pliers to flatten the edges of these brackets right next to the holes. These bracket will be sandwiched between the plate and the frame.

Support the Front Skid Plate in position and use the 3/8" Button Head bolts with flat washers to attach to the Engine Skid plate by bolting to the nut plate.

Attach the front lip of the skid plate to the cross member. Use the supplied M10 bolts with M10 washers in 1st and 4th slot location from the left side (looking towards the front of the truck). Use two more M8 bolts with M10 washers on the locations where the power steering brackets are located.

Hint: Do not tighten at this time.

Hardware:

- 1 - Nut Plate (4 Nuts)
- 2 - M10 x 30mm - Flange Bolt - [1.25 pitch] class 10.9 zinc clear
- 4 - M10 - Washer - Thick 25mm OD zinc clear
- 2 - M8 x 35mm - Flange Bolt - [1.25 pitch] zinc clear
- 4 - Button Head Cap Screw 3/8-16 x 1-1/4"
- 4 - Flat Washer 3/8" USS



Step 7: Insert nut plate on lip of Engine Skid Plate



Step 7: One of the power steering line brackets flattened.

Slee Off-Road – [Lexus GX470 & GX460, FJ Cruiser, 5th Gen 4Runner Skid Plate System]
(SOK2080 or SOK2087) – Installation instruction 8

7 –Continued:

Photograph shows the locations of the attachment bolts for the Front Skid Plate.

Arrows indicate the M10 bolts and other bolts are M8.

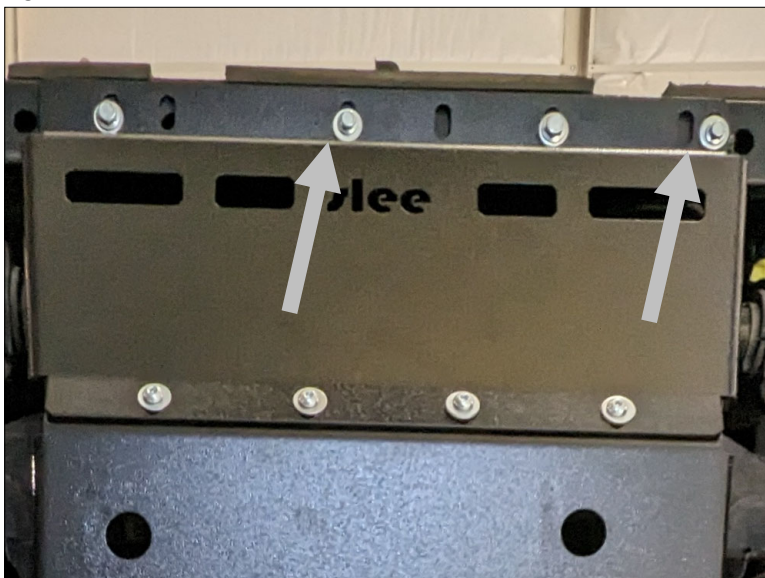

Step 7: Bolt locations for Front Skid Plate. Arrows indicate M10 bolt locations.

8 Install the Drain Plug Cover Plate onto the Engine Skid Plate. The 4) 3/8x1" counter sunk bolts will be screwed into the square spring nuts installed earlier. Tighten at this time.

Hardware:

4 - Flat Head Cap Screw 3/8-16 x 1-1/2"

9 Torque all hardware to spec

All M8 hardware —20ftlb

All 3/8" and M10 hardware - 30 ftlb

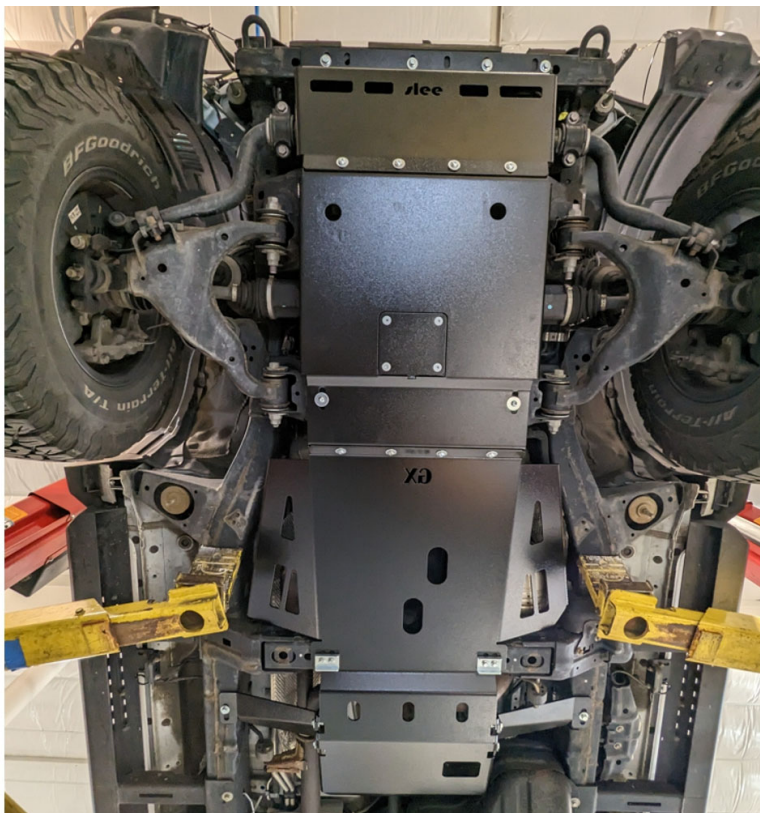

Step 9: Completed Installation